

投票站位置圖和禁止拉票區 Polling Station - Location Plan & No Canvassing Zone

投票站編號 Polling Station Code	2018年立法會補選地方選區編號及名稱 Code & Name of Geographical Constituency for 2018 Legislative Council By-election	名稱及地址 Name & Address
<b>R3001</b>	<b>LC5</b> 新界東 <b>NEW TERRITORIES EAST</b>	吳氏宗親總會泰伯紀念學校 新界沙田馬鞍山錦英苑 <b>Ng Clan's Association Tai Pak Memorial School</b> <b>Kam Ying Court, Ma On Shan, Sha Tin, New Territories</b>

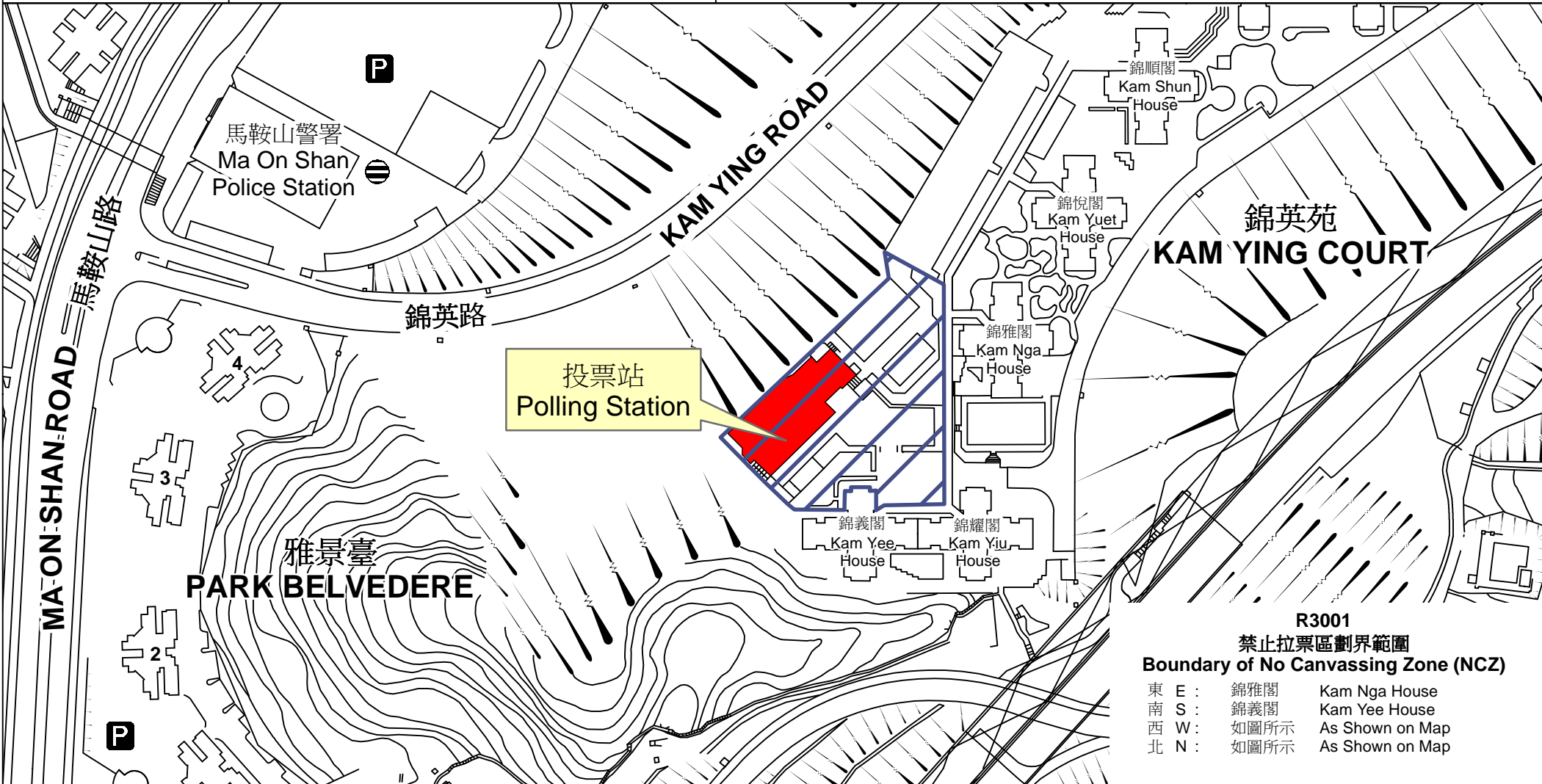

**R3001**  
**禁止拉票區劃界範圍**  
**Boundary of No Canvassing Zone (NCZ)**

東 E :	錦雅閣	Kam Nga House
南 S :	錦義閣	Kam Yee House
西 W :	如圖所示	As Shown on Map
北 N :	如圖所示	As Shown on Map

 禁止拉票區  
No Canvassing Zone